

MHT LIGHTING

PoE FIXTURE

Line Voltage Fixture

STRIP Series

LED WRAPAROUND Series

FEATURES

- PoE Enabled that works with Inspextor
- 0-10V Line Voltage Available
- Multiple mounting options

GENERAL INFORMATION

| | |
|----------------|---|
| Applications | Corporate Campuses, Data Centers, Education, Retail, and Healthcare Facilities |
| Warranty | 10-Year Limited Warranty |
| Construction | Steel Construction Housing with Highly Reflective White Coating Lens: Clear Prismatic Polycarbonate |
| Certifications | |



PRODUCT DATA

| | |
|-----------------|--|
| Electrical | Remote PoE Low Voltage Driver Node or Intergrated 0-10V LED Driver |
| Mounting | Suspended Cable Mount / Ceiling/Wall Surface Mount |
| Lumens | 3,780-12,150 Lumens |
| Max Input Power | PoE:28W/48W Line Voltage: 90W |
| CRI | > 80 |
| CCT | 3000K/3500K/4000K/5000K |
| L70 Lifetime | > 50,000 Hours |
| Rated Lifespan | > 100,000 Hours |
| Dimensions | 4FT: 48" x 3.35" x 3.58" 8FT: 98.7" x 3.35" x 3.58" |

ORDERING INFO: Sample Code - MHTI-STRP-ECO-SC-4FT-28E-4K-SM

| Series | Size & Wattage | Color Temperatures | Mountings | Options |
|----------------------------------|--|---|---|---|
| MHT-STRP | | | | |
| PoE:MHTI-STRP-SC LV:MHTL-STRP | 4FT-28W/48W/40W (PoE/PoE/ LV) 8FT-70W/90W (LV) | 3K - 3000K 35K - 3500K 4K - 4000K 5K - 5000K AT - Tunable 2700K to 5700K | AC - Suspended Cable Mount SM - Ceiling/Wall Surface Mount | (Blank) - Standard in White SPD - 10kV Surge Protective Device |



DIMENSIONS

Unit: mm

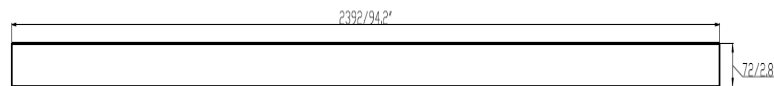
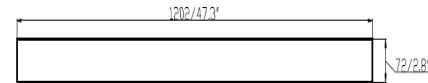
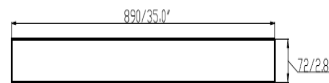
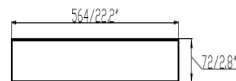

PHOTOMETRICS

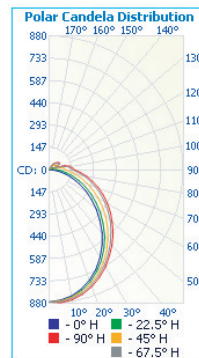

| Illuminance at a Distance | | | |
|---------------------------|---------|------------|---------|
| Center Beam fc | | Beam Width | |
| 1.5ft | 385 fc | 3.4 ft | 5.4 ft |
| 3.0ft | 96.3 fc | 6.7 ft | 10.8 ft |
| 4.5ft | 42.8 fc | 10.1 ft | 16.2 ft |
| 6.0ft | 24.1 fc | 13.4 ft | 21.6 ft |
| 7.5ft | 15.4 fc | 16.8 ft | 27.0 ft |
| 9.0ft | 10.7 fc | 20.1 ft | 32.4 ft |

■ Vert. Spread: 96.4°
■ Horiz. Spread: 121.9°

FIXTURE PERFORMANCE

| Model | Max Wattage | Lumens/Watt |
|--------------|-------------|-------------|
| MHT-STRP-4FT | 28/40/48W | 135 lm/W |
| MHT-STRP-8FT | 90W | 135 lm/W |

MHT Technologies